

QANBA

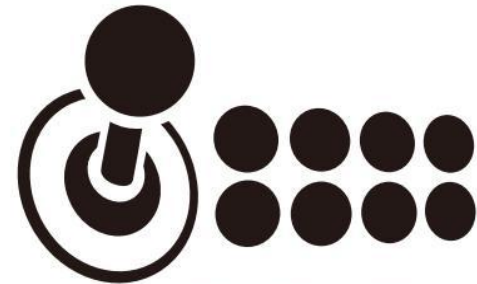

2009

2009 ARCADE

2009-IP

Installation manual

QANBA 2009
Arcade

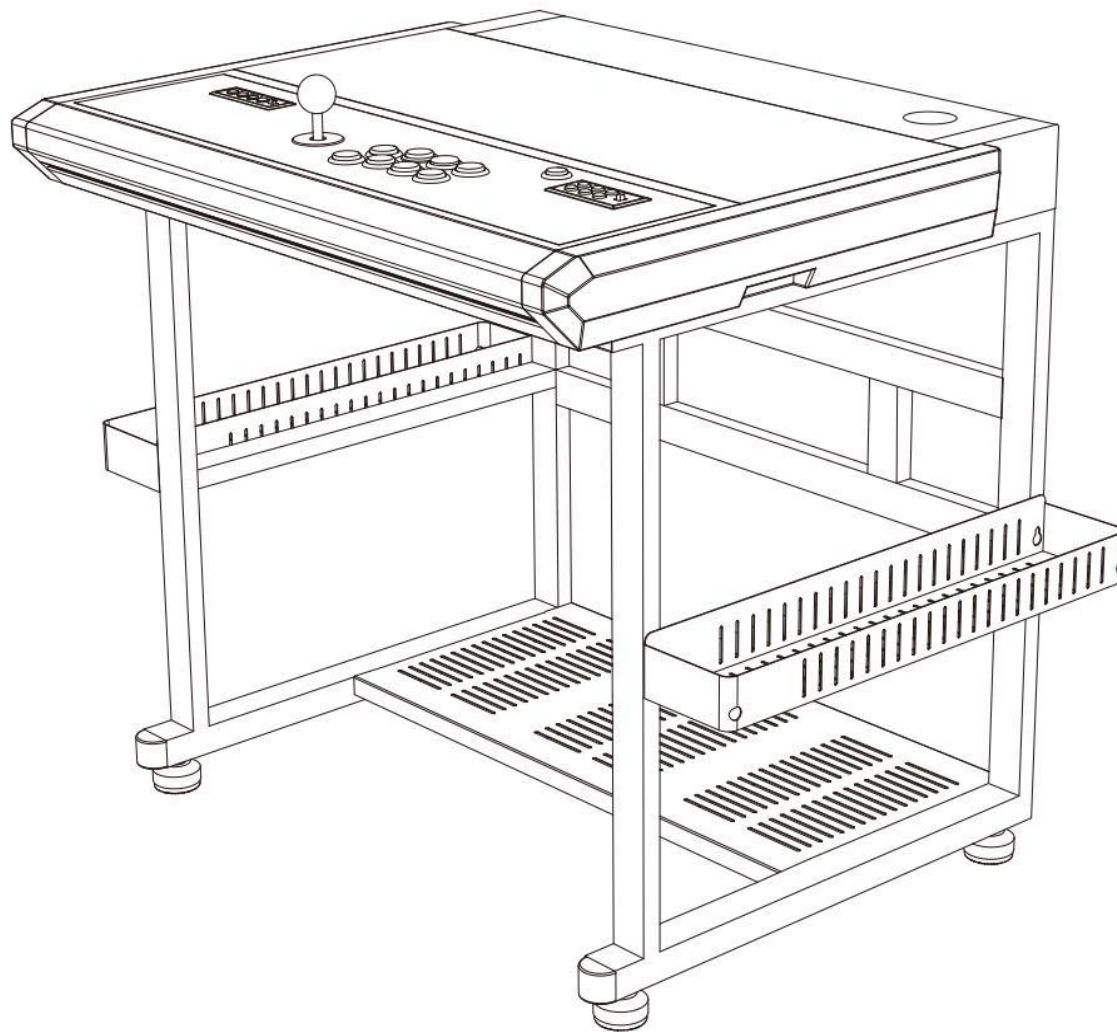

Control console packing box material list

① Console x 1, Floor Protector Mat x 2

* Please open both boxes and check the quantity of all items

K Console

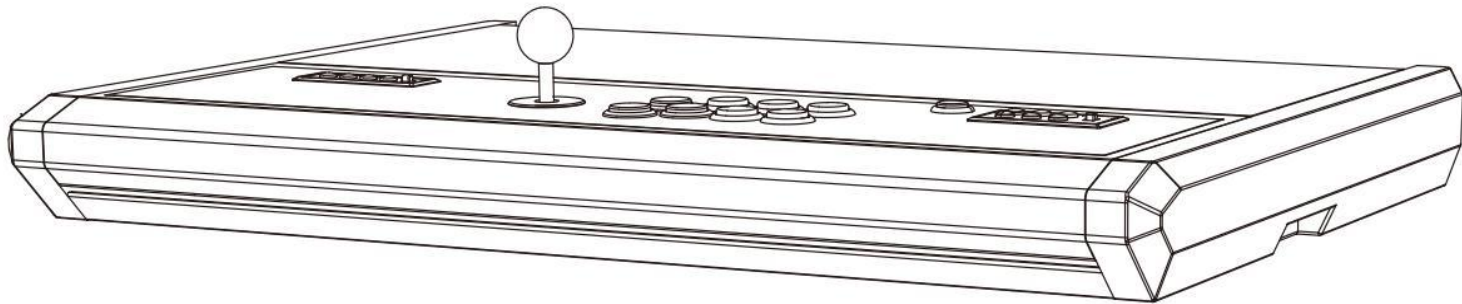

I Joystick guard
(on console)

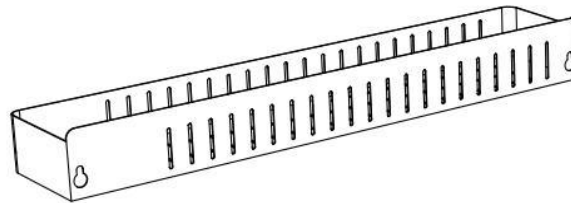

J Storage baskets
(x2)

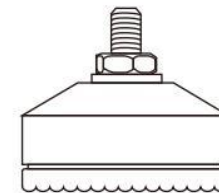

G Floor protector
mat (x4)

List of materials prepared before installation

Installation preparation: Console

* Please read the installation manual carefully

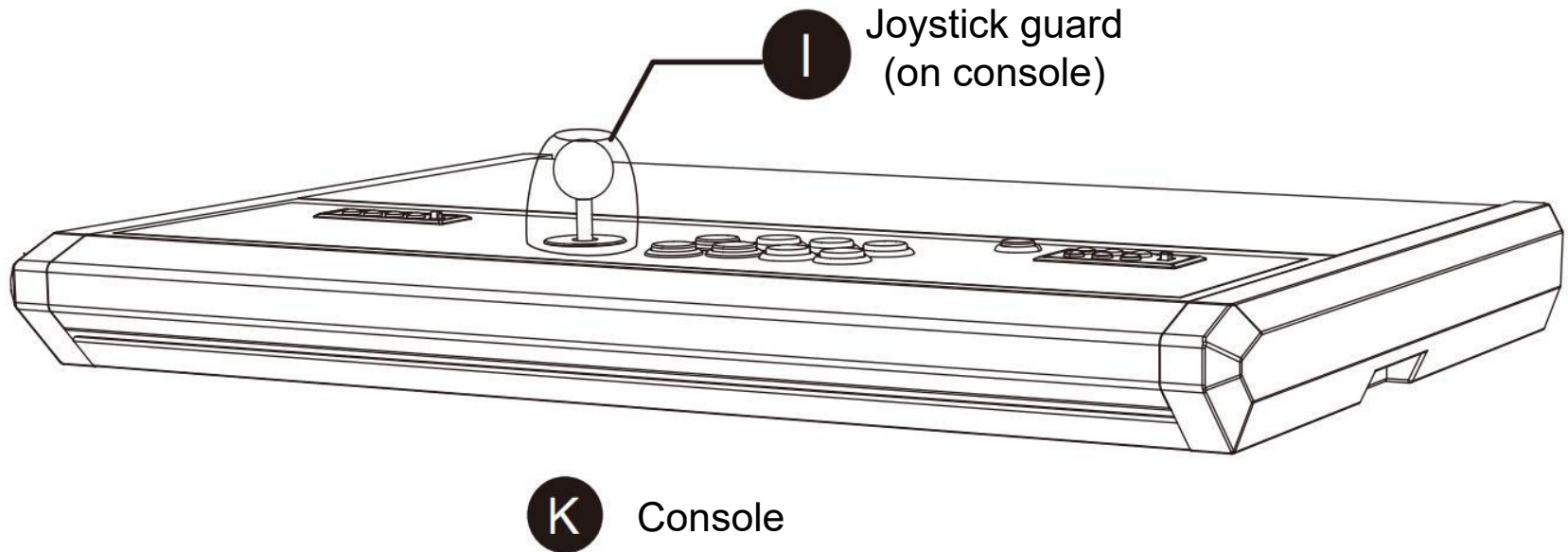

Accessory box: Phillips screwdriver x 1, 6x30mm Screw x 4,
6-inch cable ties x 12, 10-inch cable ties x 25,
USB cable x 4 (Reserve on demand)

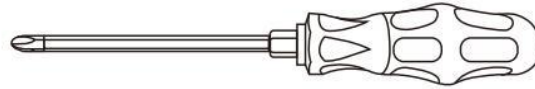

Q 6x30mm
screw (x 4)

O Phillips screwdriver

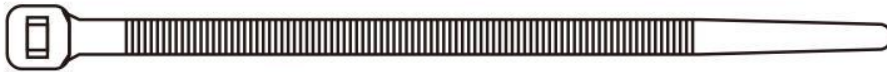

L 6-inch cable ties (x 12)



M 10-inch cable ties (x 25)

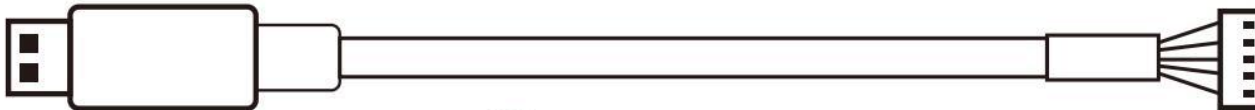

N USB cable (x 4)

Step 1: Install console components

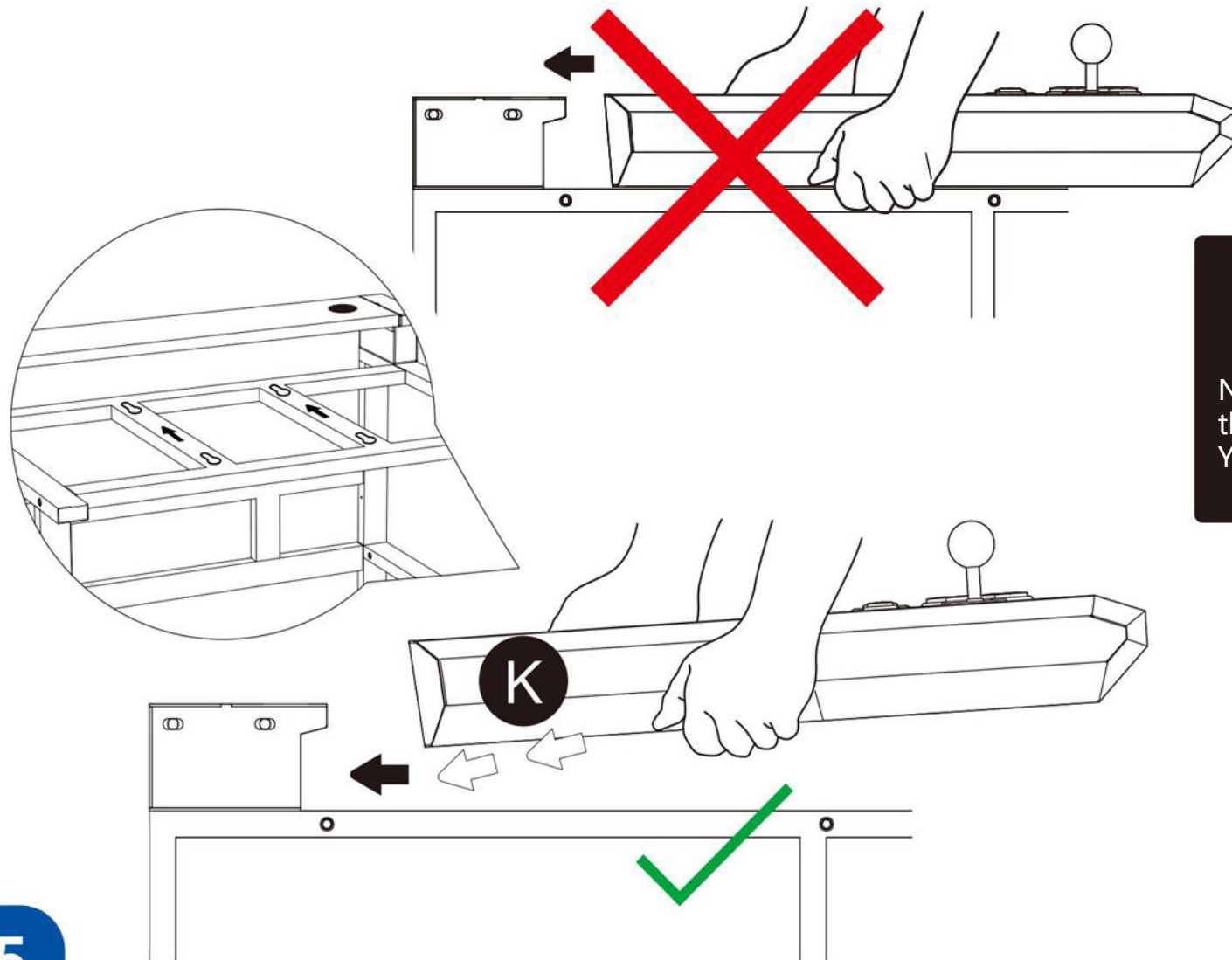

Note: When installing the console, tilt it in. You can't just push it in.

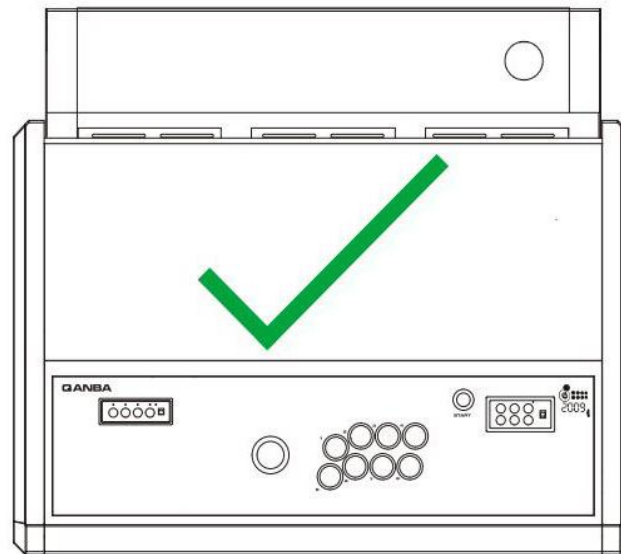
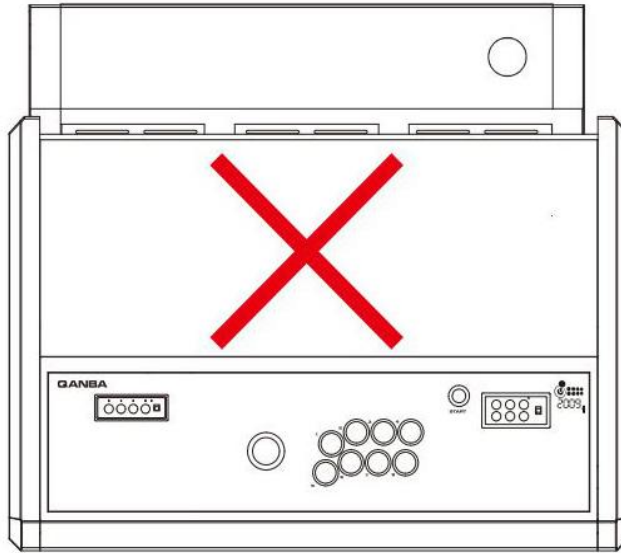

Note: Align both sides when installing, do not shift the center

Step 2: Secure the console using a Phillips screwdriver (O) and four 6x30mm screws (Q)



Clockwise
tightening

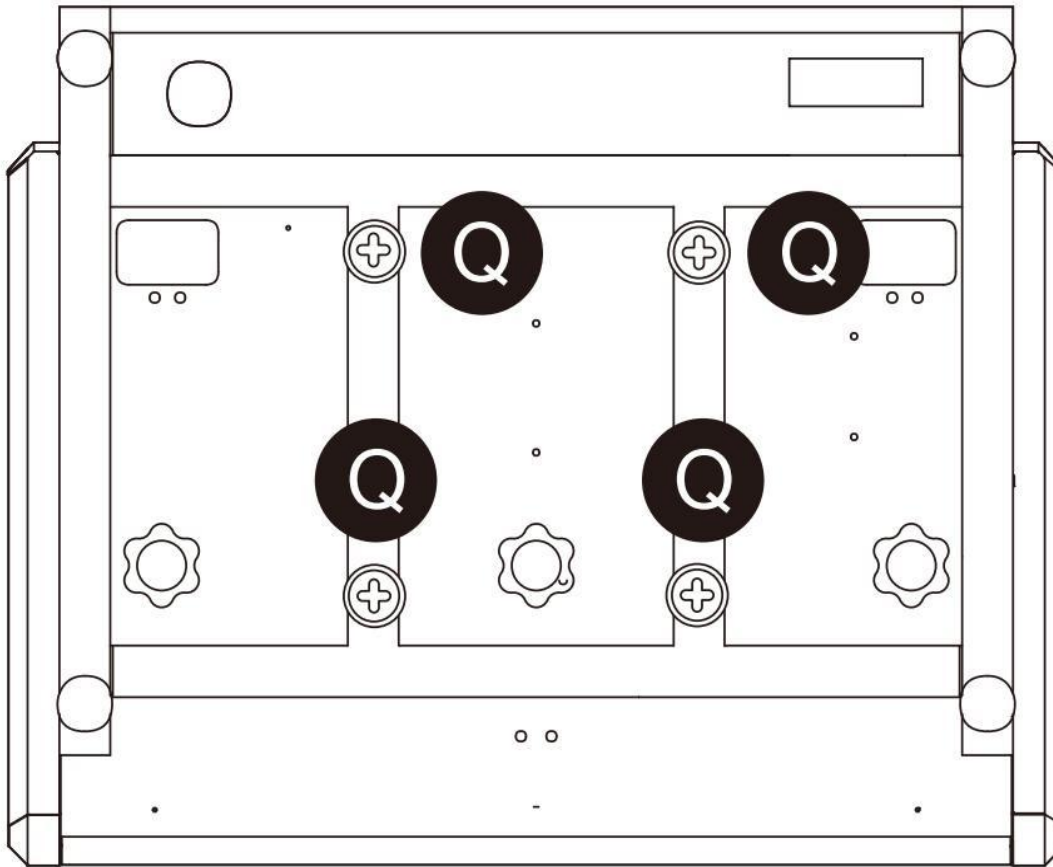

Internal cable installation

Step 1: Open the console panel by unscrewing the three pin hand screws (P) at the bottom of the console.

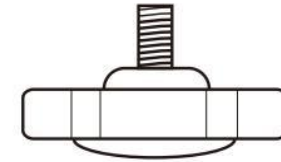

3 x **P**



Unscrew
counterclockwise

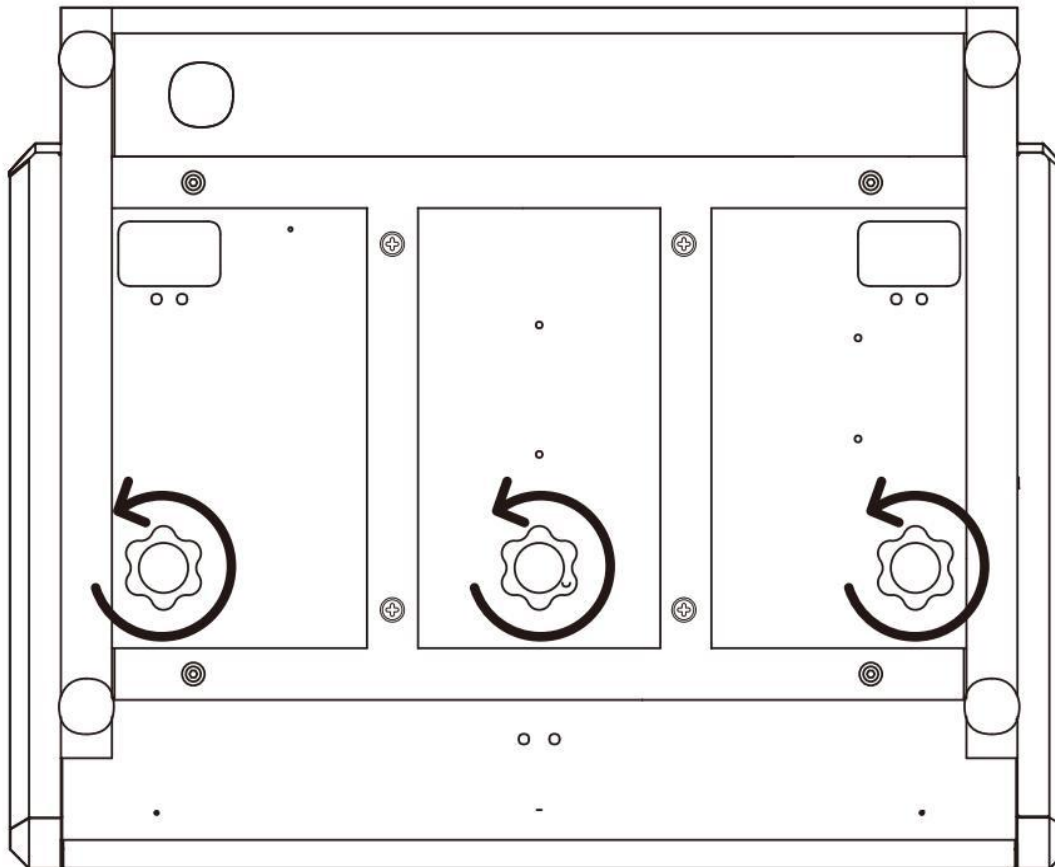

Step 2: Open the panel from the console and use a phillips screwdriver (O) to remove the M4 screw (R) that locks the motherboard area in the console.



Unscrew
counterclockwise

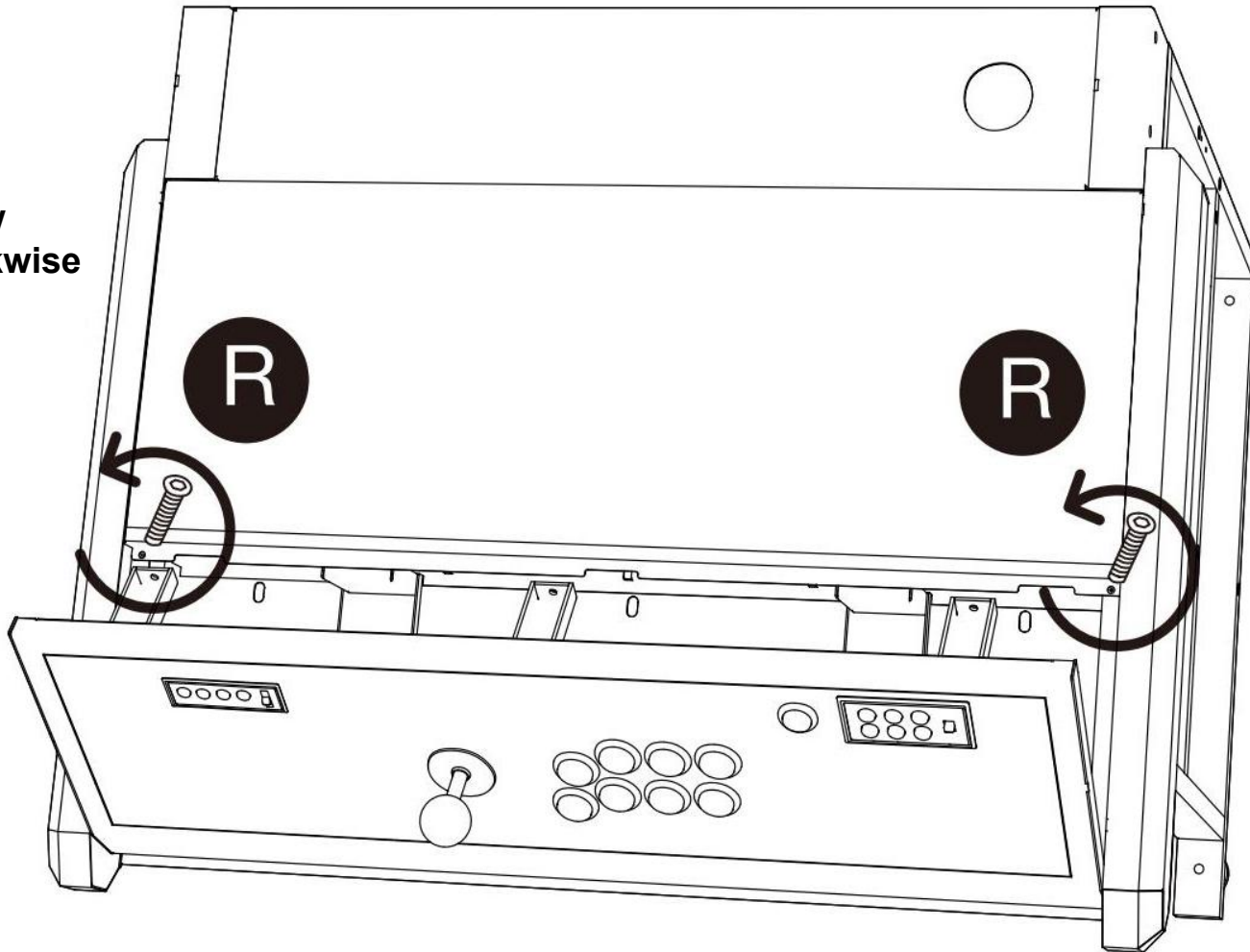

Step 3: Open the mainboard area and insert the USB port of the USB cable (N) through the square hole at the bottom of the console.

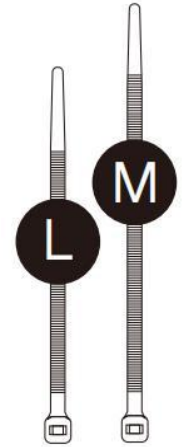
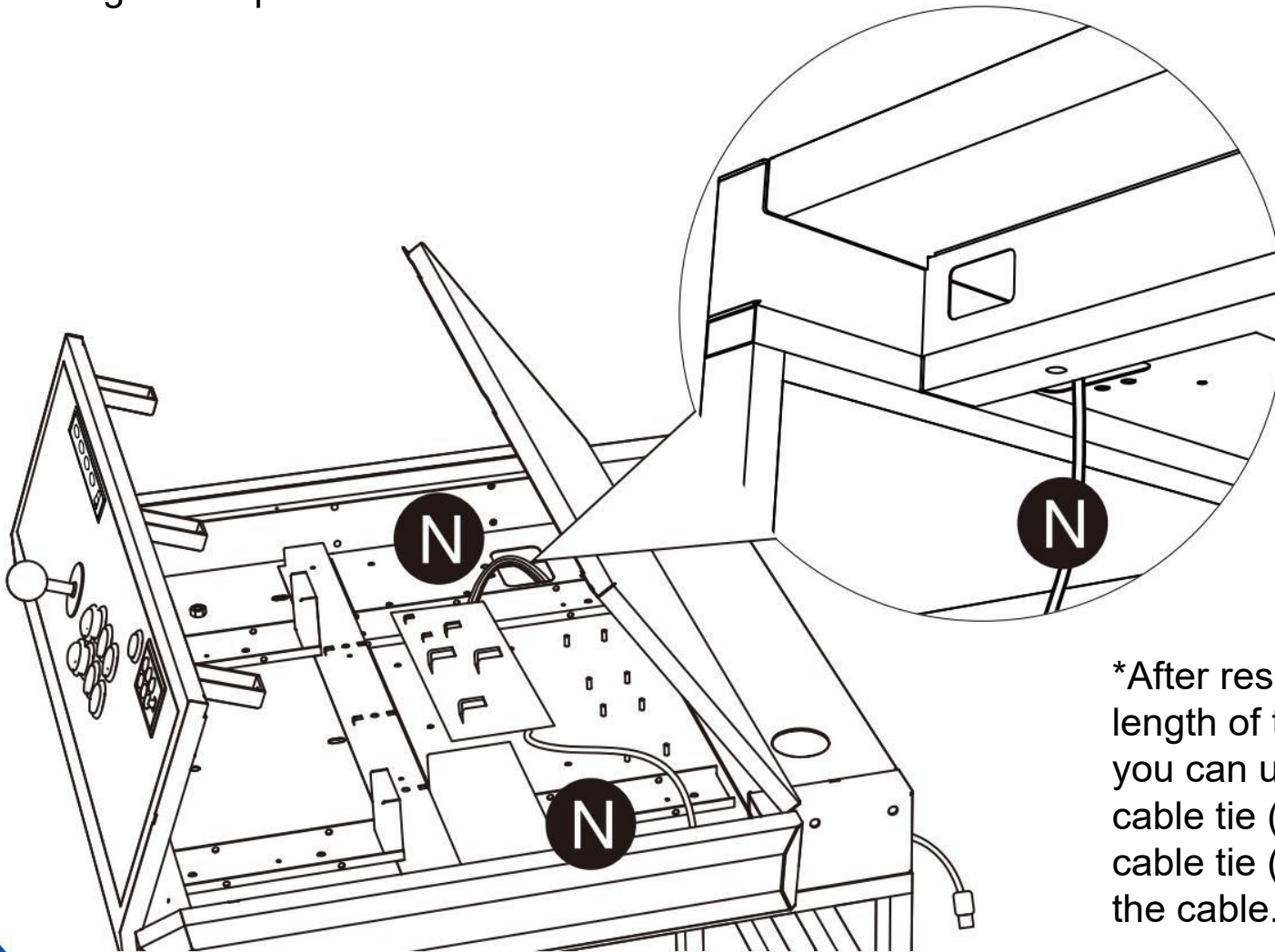

*After reserving sufficient length of the USB cable, you can use a 6-inch cable tie (L) or 10-inch cable tie (M) to arrange the cable.

Step 4: Cover the motherboard area panel and reinstall it with the M4 screw (R) you just removed. And cover the console panel.



**Clockwise
tightening**

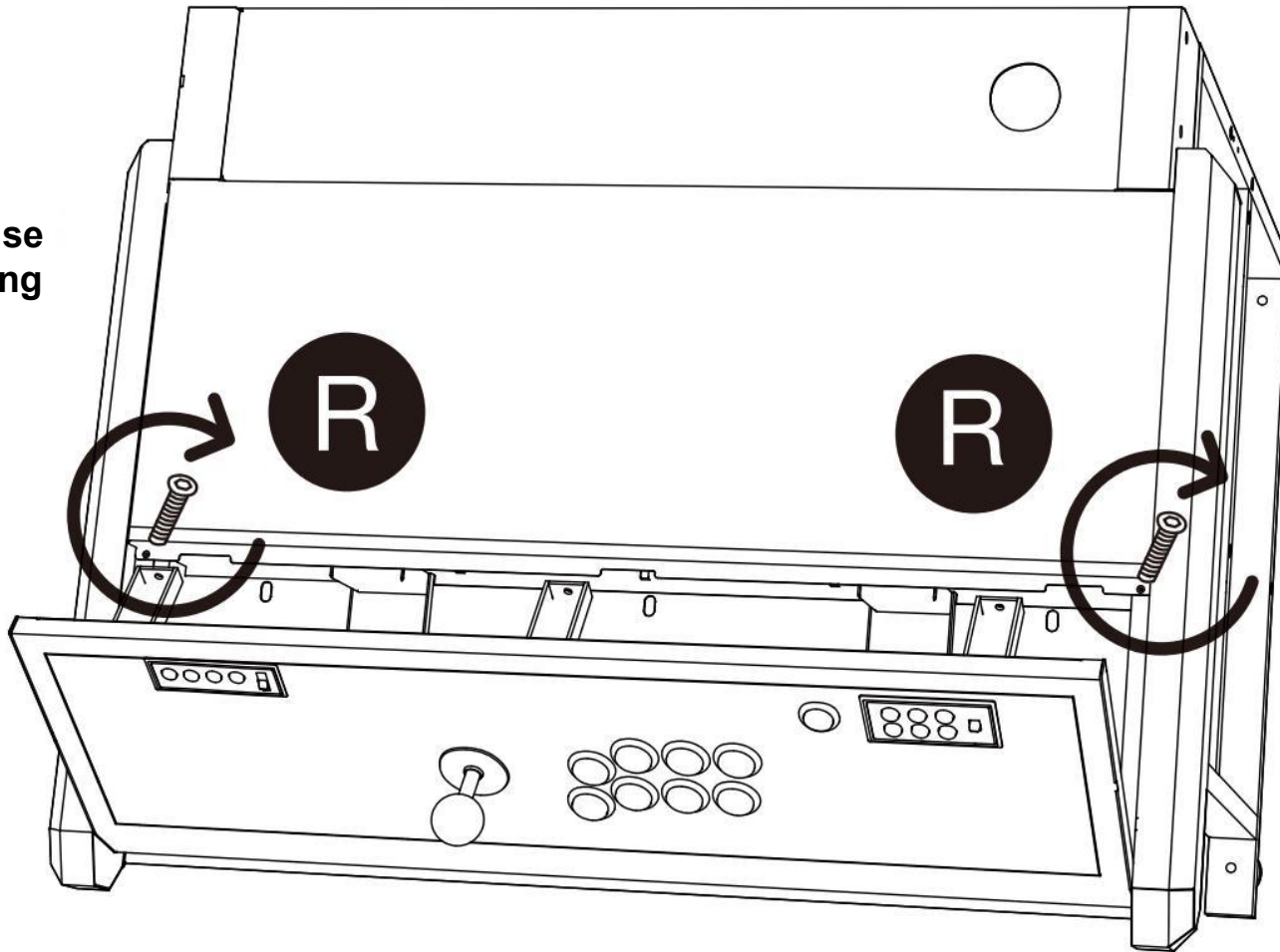

Step 5: Reinstall and tighten the three plum hand screws at the bottom of the console.



**Clockwise
tightening**

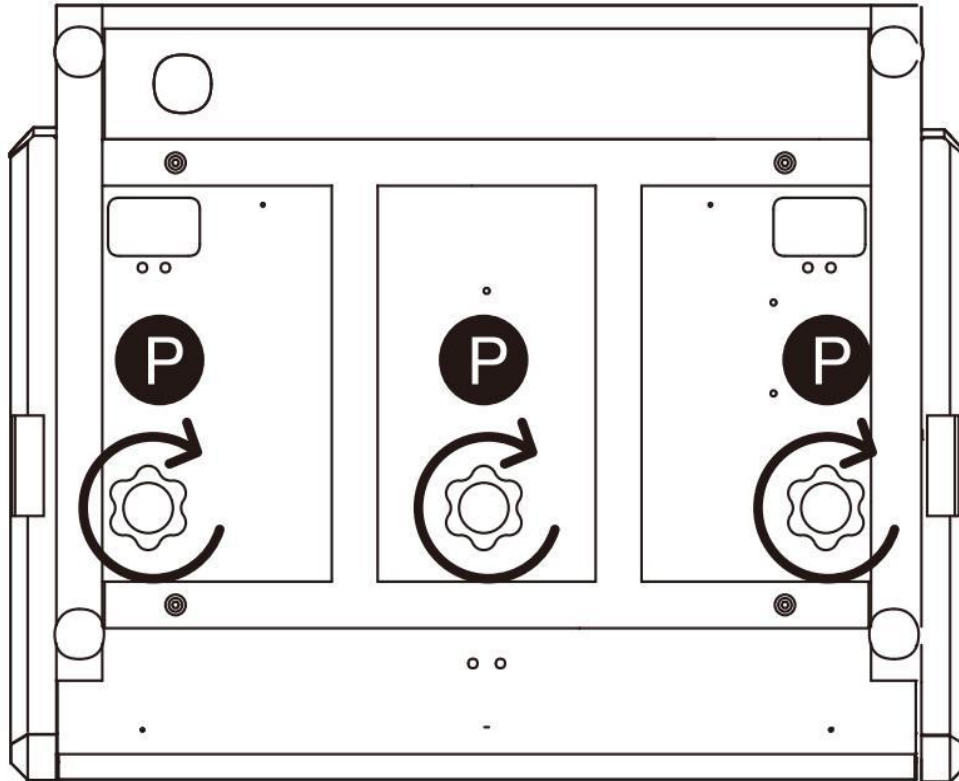

Display connection and installation

Depending on your needs, you can place the monitor on the platform, or use a third-party monitor holder (30mm thickness on the back of the table) to install it.

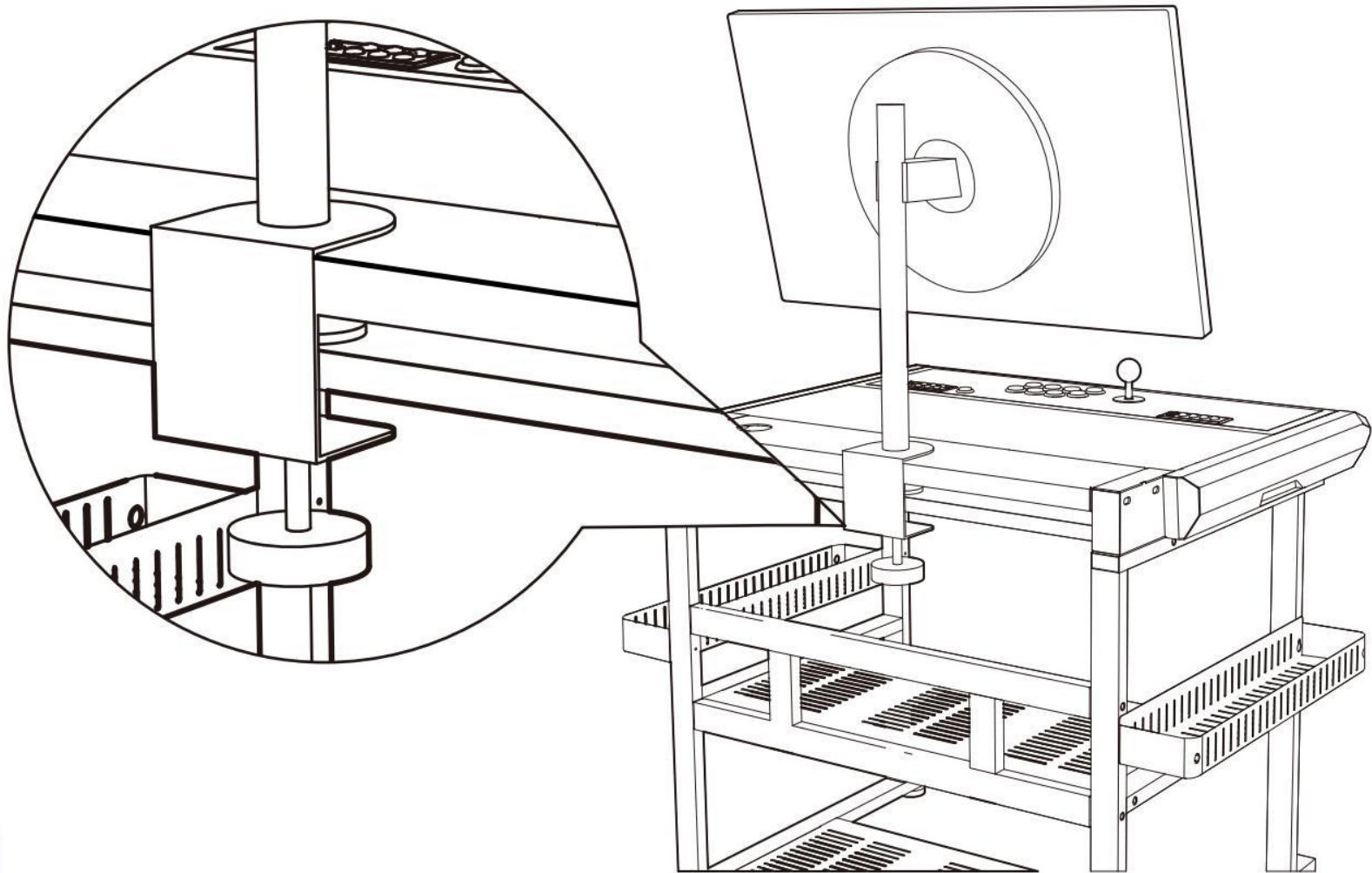

Use a 6-inch cable tie (L) or a 10-inch cable tie (M) to arrange the wire as needed.



Note: This product does not contain monitor and monitor stand, please install according to the actual situation.

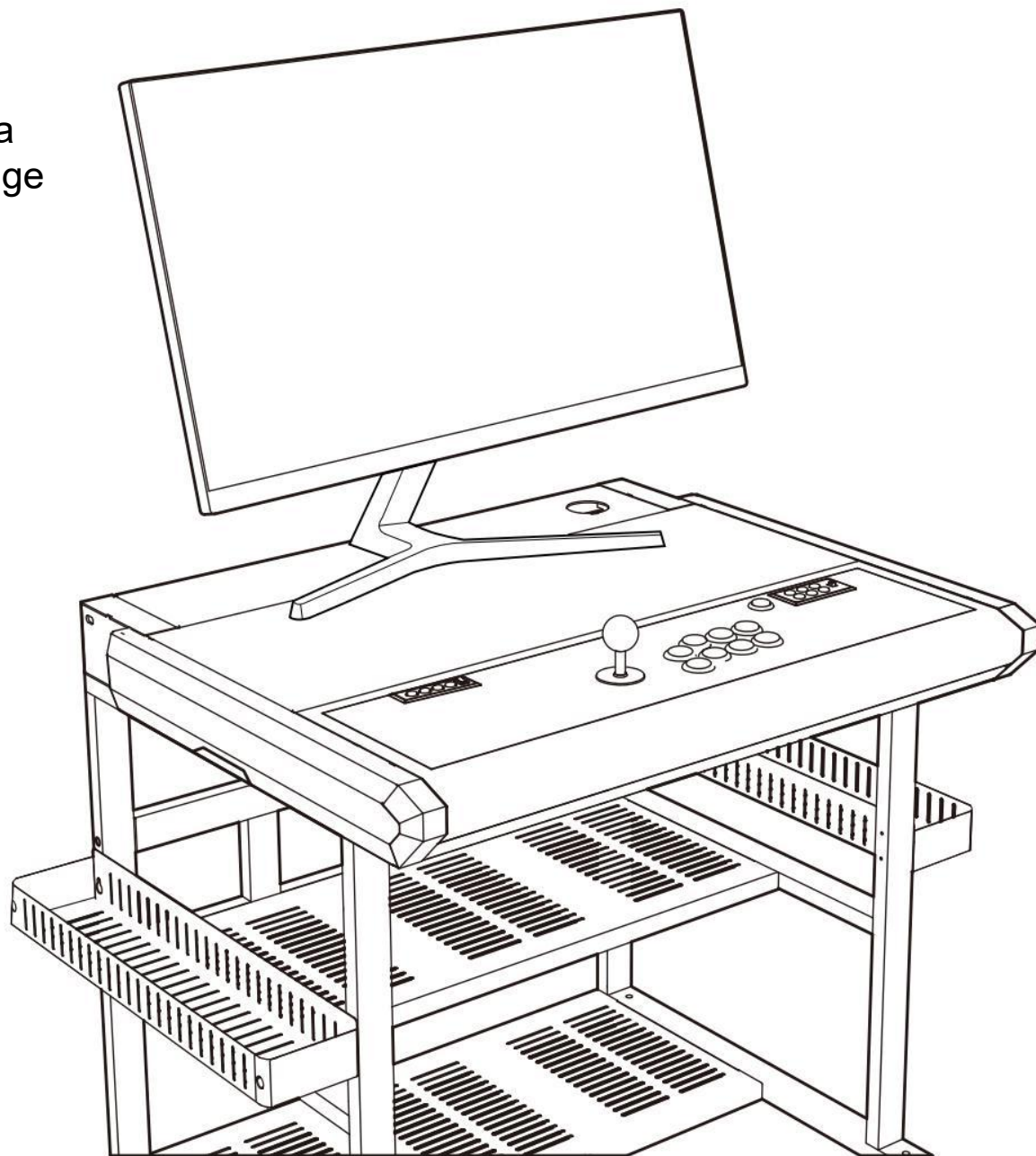

Characteristics

Compatible button

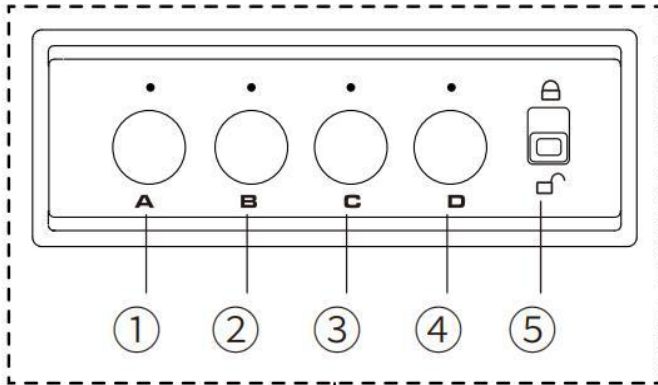

Function button

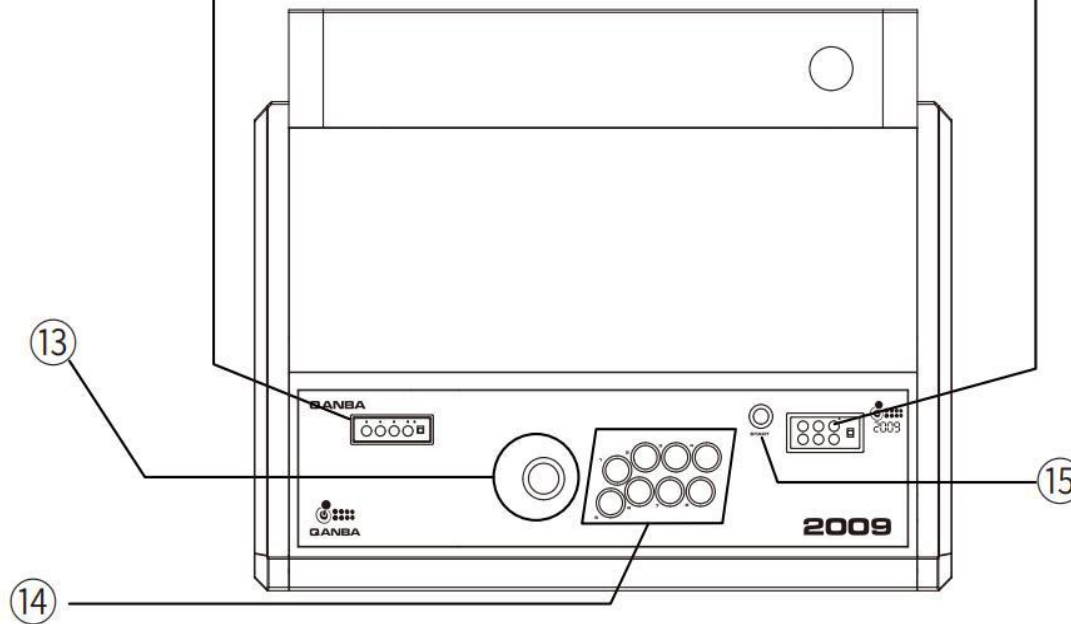
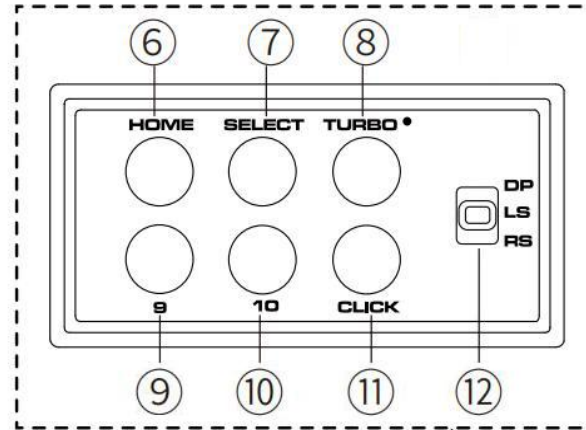

- ① Compatible button A
- ② Compatible button B
- ③ Compatible button C
- ④ Compatible button D
- ⑤ Tournament mode switch
- ⑥ HOME button
- ⑦ SELECT button
- ⑧ Turbo function button
- ⑨ LS button
- ⑩ RS button
- ⑪ CLICK button
- ⑫ Joystick mode switch
- ⑬ Directional joystick
- ⑭ Common button area
- ⑮ START button

Product operation instructions

USB output mode sliding switch

1. Flip the S1 switch on the mainboard to select the mode of connecting multiple devices through four USB cables (N), or connecting to devices through only one USB cable. When the S1 switch slides to the left, multiple device controls are connected via 4 USB cables (N); The S1 switch slides to the right to connect to the device through only one USB cable (default mode).

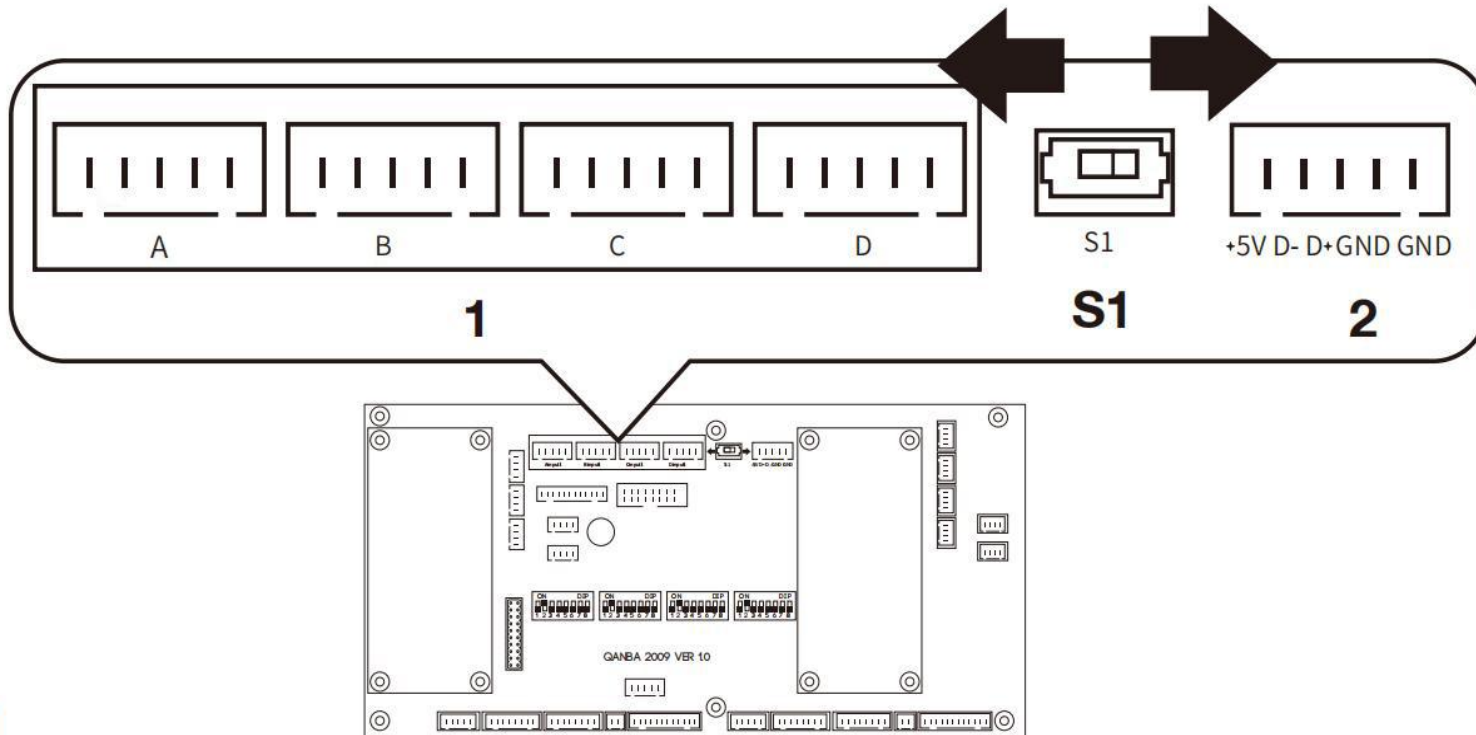

2. In the default mode, after connecting to different devices, you need to press the compatibility button to achieve the function of switching device compatibility.

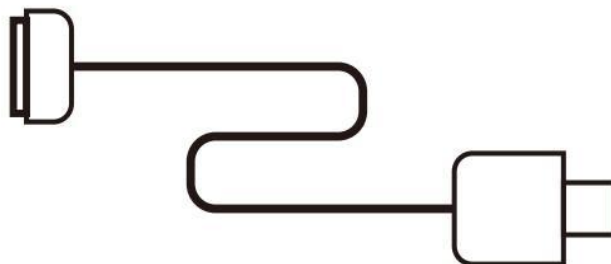
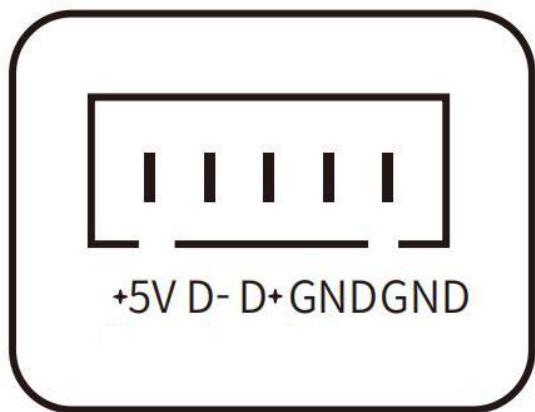

3. When multiple devices are connected using four USB cables (N), the A(1)/B(2)/C(3)/D(4) mode button is used to switch the compatibility mode. You do not need to insert or remove the USB cables of different devices.

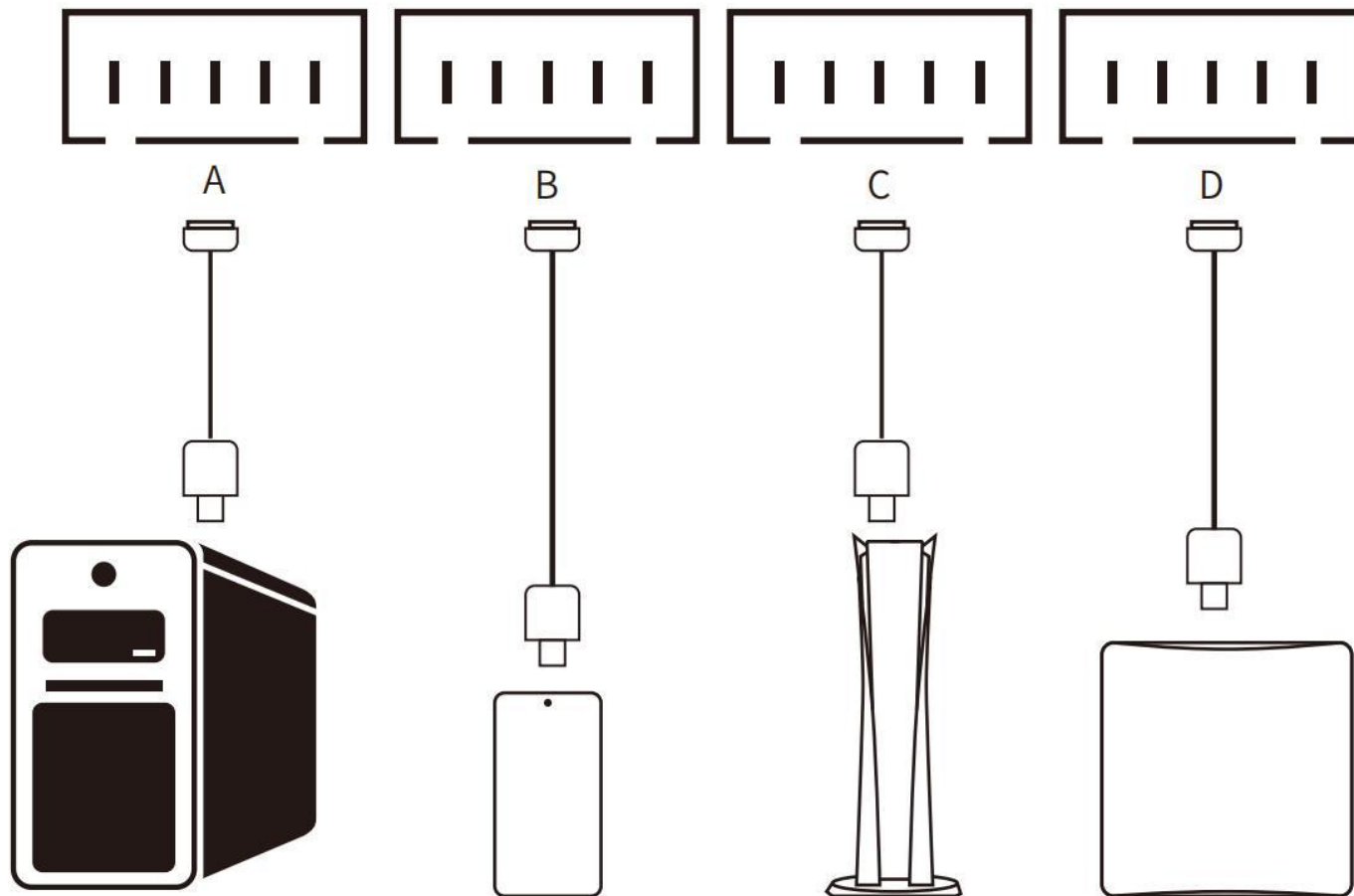

Tournament mode

1. Tournament mode switch (5) When unlocking (default), compatible buttons A/B/C.D and function buttons HOME/SELECT/TURBO can be used normally.

2. When the Tournament mode switch (5) is locked, the compatible button A/B/C.D and the function button HOME/SELECT/TURBO are unavailable.

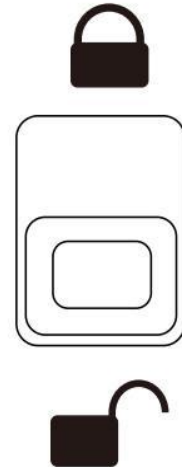

**Tournament mode
lock On**



**Tournament
mode lock off**

Joystick mode

The directional joystick (13) can slide the switch (12) through joystick mode,
Switch between the following three modes

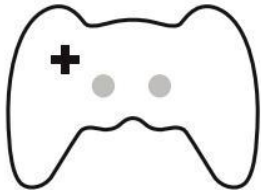
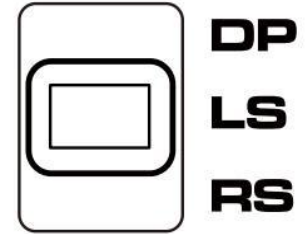

DP: Directional pad

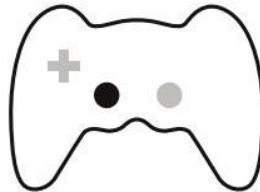

LS: Left stick

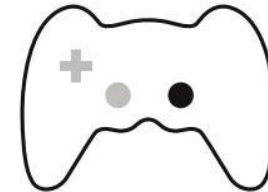

RS: Right stick

*** Some games can only use LS control mode.**

Turbo Function

Common key area (14) Each button can be switched and cycled between the following three continuous transmission modes

Repeated message mode:

- ① Continuous transmission off (default) - LED light off state;
- ② Press a button in the common key area (14), and at the same time, press the serial function button (8) to open the serial function of the button. After holding the button, the LED blinks, indicating that the button is continuously triggered by holding the button;
- ③ Press and hold the button that has turned on the continuous transmission function, and when pressing the continuous transmission function button (8), the automatic continuous transmission function of the button is turned on - the LED is always blinking, which means that the button has been triggered.

*** Reinserting the USB cable or switching to a different compatibility mode can reset the continuous messaging function to the default off state**

